

Fitting Instructions:

Speed Triple, Speed Triple S, Speed Triple R, Speed Triple RS, Street Triple, Street Triple R up to VIN 793031, Street Triple Rx, Daytona 675, Daytona 675R, Tiger XR, Tiger XR_x, Tiger XR_T, Tiger XC, Tiger XC_A, Tiger XC_x, Tiger 800, Tiger 800XC, Tiger 800 XC_x, Tiger 800 XC_A, Tiger 800 XR, Tiger 800 XR_x, Tiger 800 XR_x LRH, Tiger 800 XR_T, Tiger 1050 and Tiger Sport

A9628017, A9628018, A9620036, A9620061, A9628044 and T2025065

Thank you for choosing this Triumph genuine accessory kit. This accessory kit is the product of Triumph's use of proven engineering, exhaustive testing, and continuous striving for superior reliability, safety and performance.

Completely read all of these instructions before commencing the installation of the accessory kit in order to become thoroughly familiar with the kit's features and the installation process.

These instructions should be considered a permanent part of your accessory kit, and should remain with it even if your accessory-equipped motorcycle is subsequently sold.

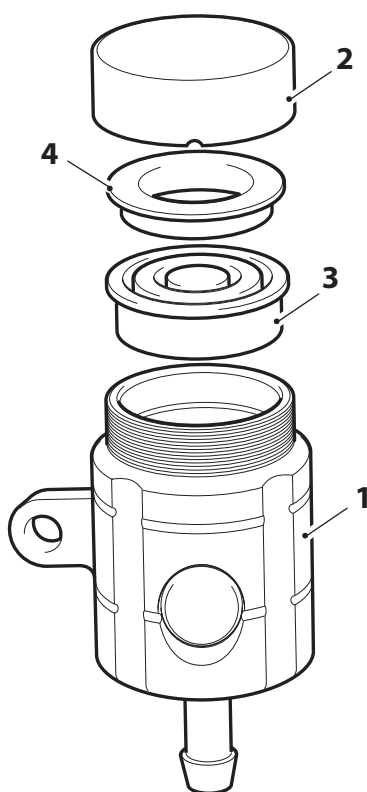

Parts Supplied:

1. Brake fluid reservoir	1 off	3. Diaphragm	1 off
2. Reservoir cap	1 off	4. Diaphragm support ring	1 off



Warning

The accessory kits covered in this instruction are designed for use on specific models of Triumph motorcycle. The accessory kits and the models applicable are listed at the start of the instruction. They should not be fitted to any other Triumph model or to any other manufacturer's motorcycle. Fitting an accessory kit to a Triumph model not listed, or to any other manufacturer's motorcycle will affect the performance, stability and handling of the motorcycle. This may affect the rider's ability to control the motorcycle and could cause an accident.



Warning

Always have Triumph approved parts, accessories and conversions fitted by a trained technician of an authorised Triumph dealer. The fitment of parts, accessories and conversions by a technician who is not of an authorised Triumph dealer may affect the handling, stability or other aspects of the motorcycle's operation which may result in loss of motorcycle control and an accident.



Warning

Throughout this operation, ensure that the motorcycle is stabilised and adequately supported to prevent risk of injury from the motorcycle falling.



Warning

A torque wrench of known accurate calibration must be used when fitting this accessory kit. Failure to tighten any of the fasteners to the correct torque specification may result in loss of motorcycle control and an accident.

Note:

- **Ensure that the appropriate Triumph Service Manual is available for reference during the fitting of this accessory kit.**

1. Position the motorcycle on a paddock stand.
2. Remove the seat as described in the Owner's Handbook.
3. **Speed Triple, Speed Triple R from VIN 461332, Speed Triple S, Speed Triple RS only:**
Release the three fixings and remove the front panel from the fuel tank.

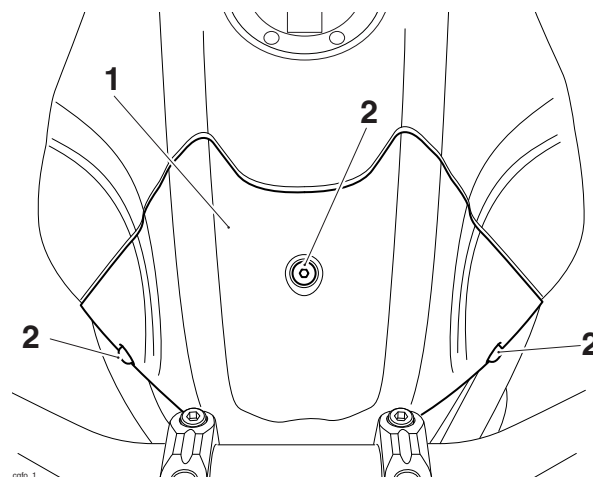

1. Front panel

2. Fixings

4. Disconnect the battery, negative (black) lead first.
5. **For Speed Triple to VIN 461331 only:**
Remove the rear bodywork as described in the Service Manual.
6. Note the position and orientation of the rear brake fluid reservoir.



Caution

To prevent paint damage, do not spill brake fluid onto any area of the bodywork. Spilled brake fluid will damage paintwork.

7. To drain the brake fluid from the rear master cylinder, attach a tube to the rear brake caliper bleed nipple. Slacken the bleed nipple and allow the brake fluid to drain into a suitable container. Operate the brake until all fluid has been expelled from the master cylinder.

8. Remove the hose from the reservoir, placing a cloth under the hose and reservoir connection to absorb any remaining fluid which may be displaced.

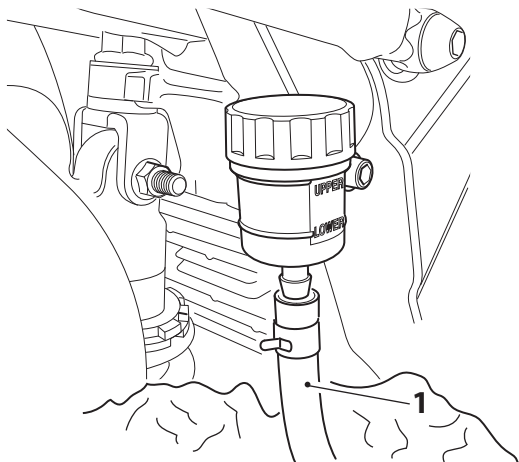

1. Hose

9. **For Daytona 675 from VIN 564948, Daytona 675 R from VIN 564948, Speed Triple to VIN 461331, Street Triple Rx, Street Triple from VIN 560477 to VIN 793031 and Street Triple R from VIN 560477 to VIN 793031:**

Remove the M6 screw and nut securing the fluid reservoir and remove the reservoir. Retain the M6 screw and nut for re-use. Retain the fluid reservoir if the motorcycle is to be returned to its original condition.

10. **For Speed Triple from VIN 461332, Speed Triple R, Speed Triple S, Speed Triple RS, Street Triple to VIN 560476, Street Triple R to VIN 560476, Daytona 675 up to VIN 564947, Daytona 675 R up to VIN 564947, Tiger XR, Tiger XR_x, Tiger XC, Tiger XC_A, Tiger XC_x, Tiger 800, Tiger 800 XC, Tiger 800 XC_x, Tiger 800 XC_A, Tiger 800 XR, Tiger 800 XR_x, Tiger 800 XR_x LRH, Tiger 800 XR_T, Tiger 1050, Tiger Sport models:**

Remove the M6 screw and washer securing the fluid reservoir as shown below. Remove the reservoir. Retain the M6 screw and washer for re-use. Retain the fluid reservoir if the motorcycle is to be returned to its original condition.

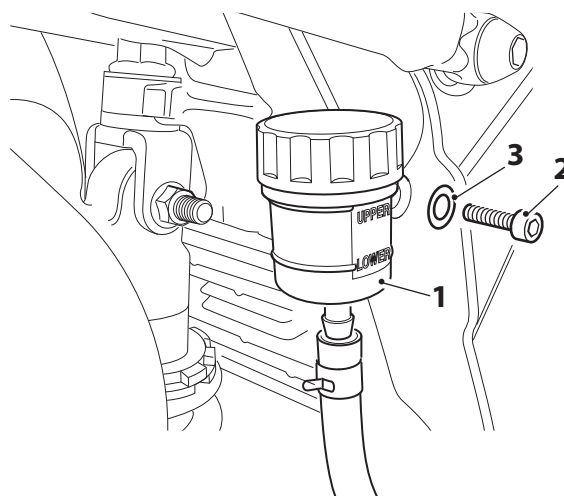

1. Fluid reservoir

2. M6 screw

3. Washer, if fitted

11. Locate the new fluid reservoir into position, ensuring the position and orientation is the same as the original reservoir, as noted on removal. Ensure the reservoir is held in a horizontal position when the motorcycle is upright.
12. **For Speed Triple to VIN 461331:**
Secure the new fluid reservoir with the original M6 screw and nut. Tighten to **3 Nm**.
13. **For Daytona 675 from VIN 564948, Daytona 675 R from VIN 564948, Street Triple Rx, Street Triple from VIN 560477 to VIN 793031 and Street Triple R from VIN 560477 to VIN 793031:**
Secure the new fluid reservoir with the original M6 screw and nut. Tighten to **6 Nm**.
14. **For Speed Triple from VIN 461332, Speed Triple S, Speed Triple R, Speed Triple RS:**
Secure the new fluid reservoir with the original M6 screw and washer and tighten to **5 Nm**.

15. **For Street Triple to VIN 560476, Street Triple R to VIN 560476, Daytona 675 up to VIN 564947, Daytona 675 R up to VIN 564947, Tiger XR, Tiger XR_x, Tiger XR_T, Tiger XC, Tiger XCA, Tiger XC_x, Tiger 800, Tiger 800 XC, Tiger 800 XC_x, Tiger 800 XCA, Tiger 800 XR, Tiger 800 XR_x, Tiger 800 XR_x LRH, Tiger 800 XR_T, Tiger 1050 and Tiger Sport:**
Secure the new fluid reservoir with the original M6 screw and washer. Tighten to **7 Nm**.

All Models:

16. Connect the brake fluid hose to the reservoir.



Warning

Use only DOT 4 specification brake fluid as specified in the Service Manual. The use of brake fluids other than those DOT 4 fluids listed in the Service Manual may reduce the efficiency of the braking system leading to an accident.



Warning

Ensure absolute cleanliness when adding brake fluid to the brake fluid reservoir. Do not allow moisture or debris to enter the cylinder as this will adversely affect the fluid properties. Always use fluid from a sealed container and do not use fluid from a container which has been opened for any period of time. Always check for fluid leakage around hydraulic fittings and for damage to hoses. A dangerous riding condition leading to an accident could result if this warning is ignored.



Caution

To prevent paint damage, do not spill brake fluid onto any area of the bodywork. Spilled brake fluid will damage paintwork.

Note:

- The brake fluid level must be between the upper and lower level lines with the reservoir held in a horizontal position, as shown below.

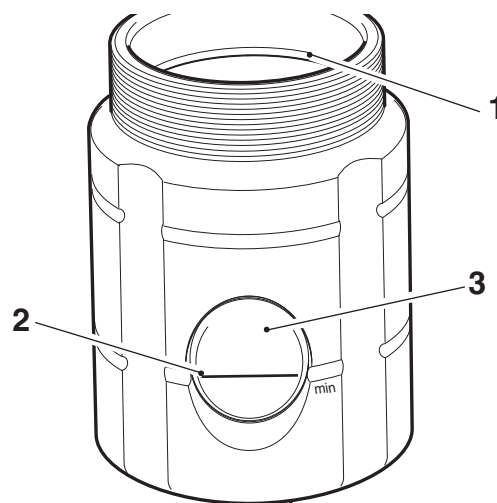

- 1. Upper level line
- 2. Lower level line
- 3. Window

17. Fill the fluid reservoir with new DOT 4 brake fluid and bleed the rear brake, as described in the Service Manual.
18. Fit the diaphragm and diaphragm support ring into the fluid reservoir.
19. Fit the new reservoir cap and carefully screw it down, ensuring it is fully tightened.
20. Check the operation of the rear brake. Rectify as necessary.
21. Re-connect the battery, positive (red) lead first.
22. **For Speed Triple up to VIN 461331 only:**
Refit the rear bodywork, as described in the Service Manual.
23. **For Speed Triple, Speed Triple S, Speed Triple R from VIN 461332, Speed Triple RS:**
Refit the front panel to the fuel tank and tighten the fixings to **2 Nm**.

All Models:

24. Refit the seat as described in the Owner's Handbook.



Warning

It is dangerous to operate the motorcycle with defective brakes; you must have your authorised Triumph dealer take remedial action before you ride the motorcycle again. Failure to take remedial action may result in reduced braking efficiency leading to loss of motorcycle control and an accident.



Warning

If, after fitment of this accessory kit, you have any doubt about the performance of any aspect of the motorcycle, contact an authorised Triumph dealer and do not ride the motorcycle until the authorised dealer has declared it fit for use. Riding a motorcycle when there is any doubt as to any aspect of the performance of the motorcycle may result in loss of control of the motorcycle leading to an accident.



Warning

The motorcycle must not be operated above the legal road speed limit except in closed-course conditions.



Warning

Only operate this Triumph motorcycle at high speed in closed-course, on-road competitions or on closed-course race tracks. High-speed operation should only be attempted by riders who have been instructed in the techniques necessary for high-speed riding and are familiar with the motorcycle's characteristics in all conditions. High-speed operation in any other circumstances is dangerous and will lead to loss of motorcycle control and an accident.