

SERVICE DATA SHEET

Street Twin

Brakes

Brake disc maximum run out Front 0.25 mm - Rear 0.25 mm
Brake disc minimum thickness Front 5.0 mm - Rear 5.0 mm
Brake fluid DOT 4

Master Cylinders

Front brake

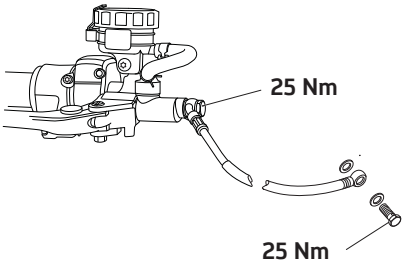

Rear brake

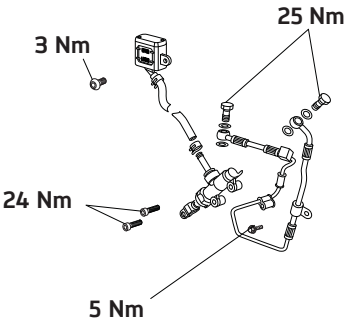

Calipers and Brake Pads

Front brake

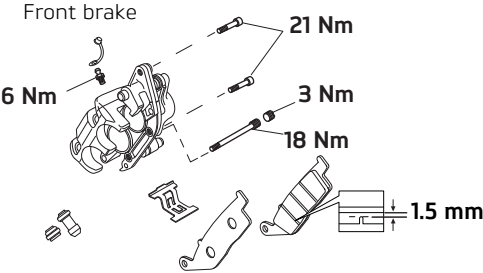

Rear brake

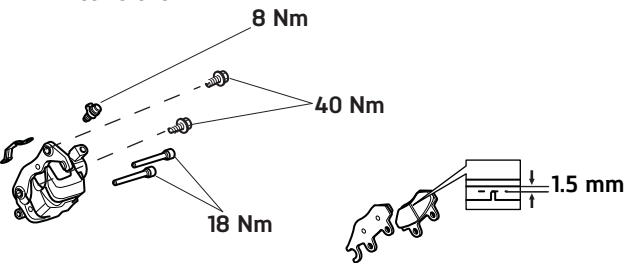

Engine and Lubrication

Oil..... Semi or fully synthetic 10W/40 or 10W/50 engine oil which meets specification API SH (or higher) and JASO MA. Triumph recommends Castrol Power 1 Racing 4T 10W/40 or 10W/50 (fully synthetic) engine oil, sold as Castrol Power RS Racing 4T 10W/40 or 10W/50 (fully synthetic) in some countries
Oil quantity..... 3.40 litres (oil and filter change). Always refer to the check sight glass for the correct level
Coolant type..... Triumph HD4X Hybrid OAT coolant (premixed as supplied by Triumph)
Coolant capacity 1.86 litres including expansion tank
Grease..... Grease to NLGI 2 specification
Camshaft cover bolts Lubricate the seals for the camshaft cover bolts with clean engine oil
Camshaft cover tightening sequence Tighten the camshaft cover bolts in the sequence shown below

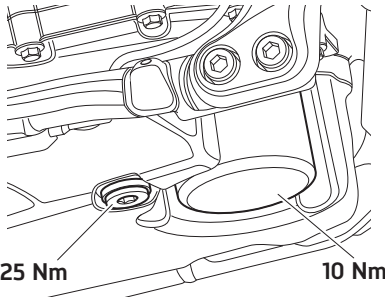
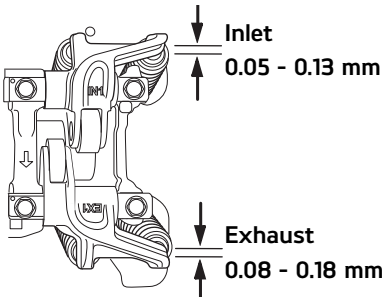
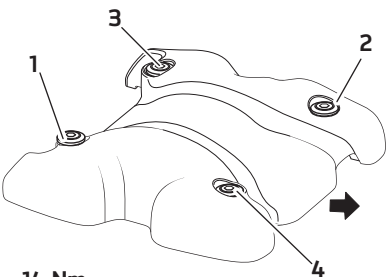

Fuel and Air

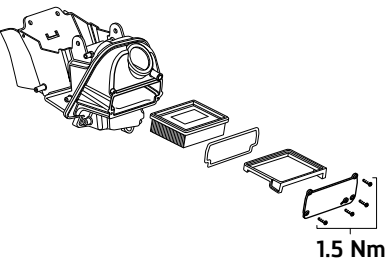
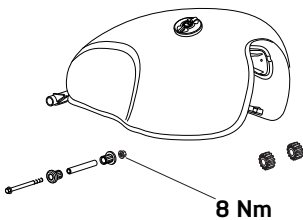

SERVICE DATA SHEET - continued

Final Drive and Clutch

Chain lubrication Chain spray suitable for O-ring chains

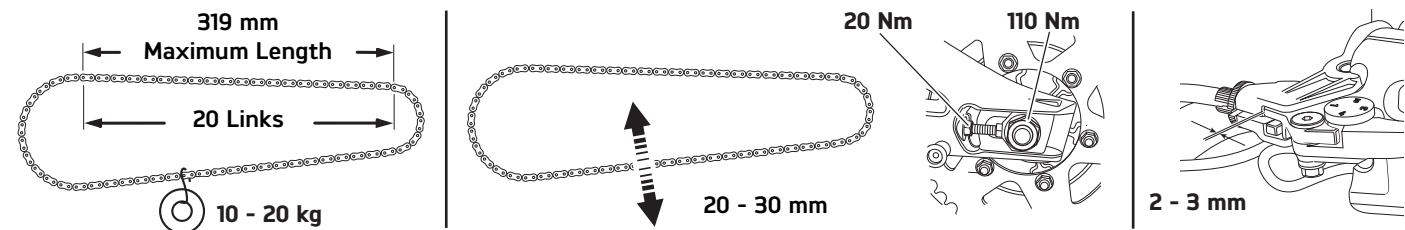

Battery and Ignition

Charge rate Must not exceed 1.0 A (refer to the Service Manual)

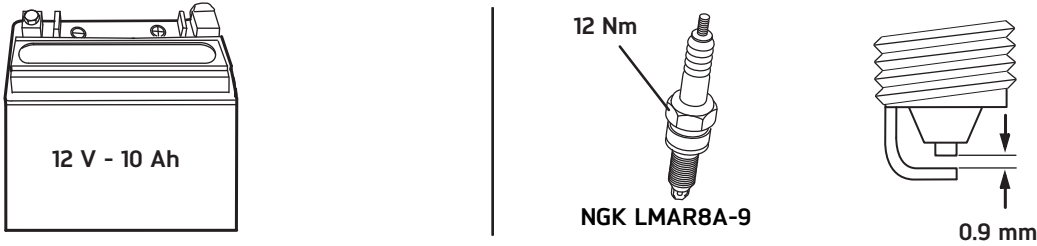

Suspension and Wheels

	Street Twin
Recommended fork oil grade	KHL34-G10(SAE10W)
Oil volume (dry fill)	478 cc
Oil level (fork fully compressed)	Right-97 mm from the top of the inner tube Left-97 mm from the top of the inner tube

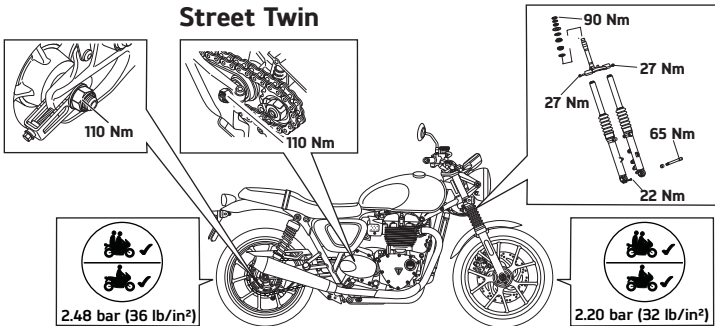

Service Parts Information

Parts Information	Description	Odometer Reading in Miles (kms), Time Period				
		500/1 month (800) Annual	10,000 (16,000)	20,000 (32,000)	30,000 (48,000)	40,000 (64,000)
For current parts information, refer to the Electronic Parts Catalogue	Sump Plug Washer	•	•	•	•	•
	Oil Filter	•	•	•	•	•
	Air Cleaner		•	•	•	•
	Spark Plug			•		•
	Camshaft Cover Seal			•		•
	Camshaft Cover Screw Seal			•		•
	Drive Chain Rubbing Strip			•		•
	Front Brake Pad Set	As necessary				
	Rear Brake Pad Set	As necessary				
Standard Service Time Allowance (Hrs.)		1.15	1.40	3.10	1.40	3.70